



# Grille



## Description

Valve for outdoor air intake and extract air discharge. Designed with a fixed louvre.  $\varnothing$  80–500 is equipped with net.  $\varnothing$  630–900 can be delivered with net to order. Mesh width 10×10 mm. Screws or nails connect to an external wall.

## Material

$\varnothing$  80–500 of casted aluminium.  
 $\varnothing$  630–1250 of galvanized sheet metal.

## Dimensions

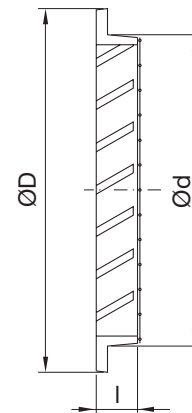

$\varnothing$ d nom	$\varnothing$ D mm	l mm	m kg
80	100	15	0,11
100	130	25	0,17
125	150	25	0,25
150	180	25	0,30
160	185	25	0,39
200	230	25	0,51
250	275	25	0,83
315	350	25	1,81
400	430	50	3,00
500	530	50	5,50
630	660	52	8,80
710	740	52	10,8
800	830	52	14,6
900	930	52	17,8
1000	1030	52	21,0
1250	1280	52	35,0

1

2

3

4

5

6

7

8

9

10

11

12

13

14

15

16

17

18



# Grille

## Technical data

1

### Sound pressure level, $L_{pA}$ , [dB]

The sound power level,  $L_{WA}$ , is shown in the graph.

2

The sound pressure level,  $L_{pA}$ , at a distance of  $d$  [m] in free field (1/4 spherical):  $L_{pA} = L_{WA} + K$  (see table).

3

d [m]	1	2	3	4	5	10	20
K [dB]	-5	-12	-15	-17	-19	-25	-30

4

### Outdoor air

5

6

7

8

9

10

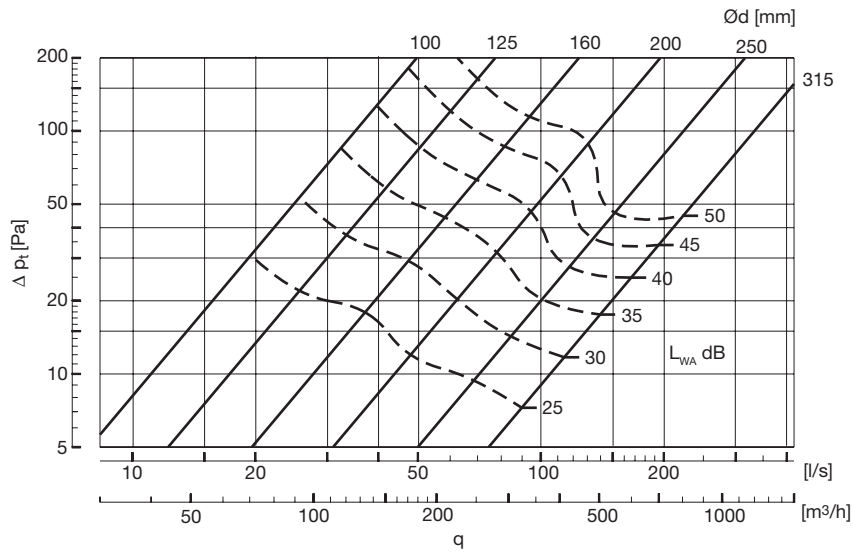

### Extract air

11

12

13

14

15

16

17

18

